

# MILD STEEL BOLTS

## ISO Metric Commercial Hex Head Bolts & Set Screws, Property Class 4.6



Bolts  
**AS 1111.1**



Set Screws  
**AS 1111.2**

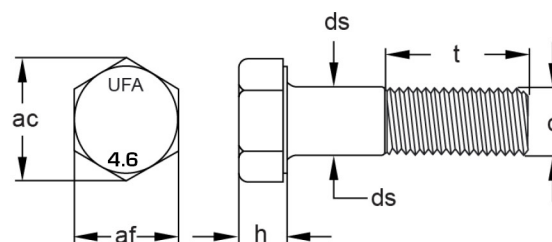

Diameter mm	Pitch mm	af		ac	h		ds		t			Spanner mm
		Min	Max	Min	Min	Max	Min	Max	L ≤ 125	L ≤ 200	L ≥ 200	
M5	0.80	7.64	8.00	8.63	3.12	3.88	4.52	5.48	16	22	35	8
M6	1.00	9.64	10.00	10.89	3.62	4.38	5.52	6.48	18	24	37	10
M8	1.25	12.57	13.00	14.20	4.92	5.68	7.42	8.58	22	28	41	13
M10	1.50	15.57	16.00	17.59	5.95	6.85	9.42	10.58	26	32	45	16
M12	1.75	17.57	18.00	19.85	7.05	7.95	11.30	12.70	30	36	49	18
M16	2.00	23.16	24.00	26.17	9.25	10.75	15.30	16.70	38	44	57	24
M20	2.50	29.16	30.00	32.95	11.60	13.40	19.16	20.84	46	52	65	30
M24	3.00	35.00	36.00	39.55	14.10	15.90	23.16	24.84	54	60	73	36
M30	3.50	45.00	46.00	50.85	17.65	19.75	29.16	30.84	66	72	85	46
M36	4.00	53.80	55.00	60.79	21.45	23.55	35.00	37.00	-	84	97	55
M42	4.50	63.10	65.00	71.30	24.95	27.05	41.00	43.00	-	96	109	65
M48	5.00	73.10	75.00	82.60	28.95	31.05	47.00	49.00	-	108	121	75
M56	5.50	82.80	85.00	93.56	33.75	36.25	54.80	57.20	-	-	137	85
M64	6.00	92.80	95.00	104.86	38.75	41.25	62.80	65.20	-	-	153	95

## BSW Hex Bolts & Set Screws, 28 tonf/in<sup>2</sup>



**AS/NZS 2451**

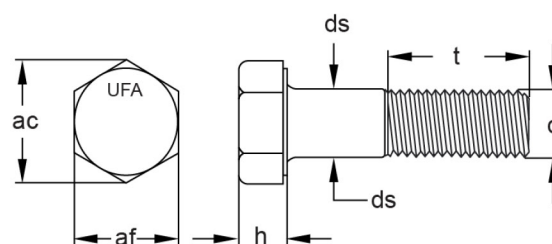

Diameter	Pitch tpi	af		ac	h		ds
		Min	Max	Max	Min	Max	Max
1/4	20	0.435	0.445	0.510	0.166	0.186	0.280
5/16	18	0.515	0.525	0.610	0.208	0.228	0.342
3/8	16	0.585	0.600	0.690	0.250	0.270	0.405
7/16	14	0.695	0.710	0.820	0.292	0.312	0.468
1/2	12	0.800	0.820	0.950	0.333	0.363	0.530
5/8	11	0.985	1.010	1.170	0.417	0.447	0.665
3/4	10	1.175	1.200	1.390	0.500	0.530	0.790
7/8	9	1.270	1.300	1.500	0.583	0.623	0.915
1	8	1.450	1.480	1.710	0.666	0.706	1.040

Nominal thread length = 2D + 1/4 inch, where D is the thread diameter

For more technical support, please contact your local **United Fasteners** branch

The content is owned and the copyright of United Fasteners Australia Pty Ltd.

## ISO Metric Cup Head Square Neck Bolts

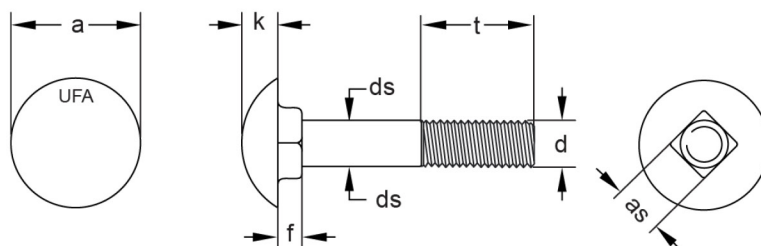

Diameter mm	Pitch mm	a		k		f		as		t		
		Min	Max	Min	Max	Min	Max	Min	Max	L ≤ 125	L ≤ 200	L ≥ 200
M5	0.80	11.14	11.25	2.50	3.10	2.50	3.10	4.52	5.48	16	22	-
M6	1.00	12.40	13.50	3.00	3.60	3.00	3.60	5.52	6.48	18	24	-
M8	1.25	16.90	18.00	4.00	4.80	4.00	4.80	7.42	8.58	22	28	41
M10	1.50	21.20	22.50	5.00	5.80	5.00	5.80	9.42	10.58	26	32	45
M12	1.75	25.70	27.00	6.00	6.80	6.00	6.80	11.30	12.70	30	36	49
M16	2.00	34.40	36.00	8.00	8.90	8.00	8.90	15.30	16.70	38	44	57
M20	2.50	43.40	45.00	10.00	10.90	10.00	10.90	19.16	20.84	46	52	65
M24	3.00	52.10	54.00	12.00	13.10	12.00	13.10	23.16	24.84	54	60	73

## ISO Metric Coach Screws

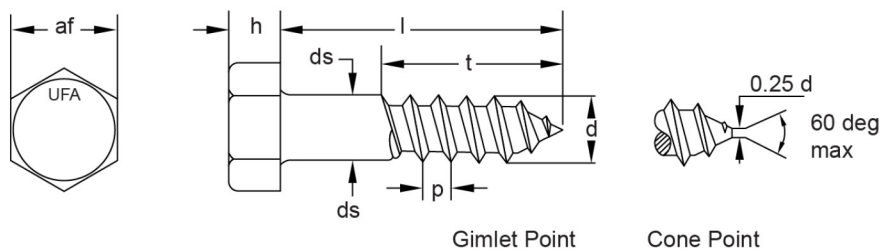

Diameter mm	af		ac	h		ds	
	Min	Max	Min	Min	Max	Min	Max
M6	9.64	10.00	10.89	3.62	4.38	5.52	6.48
M8	12.57	13.00	14.20	4.92	5.68	7.42	8.58
M10	15.57	16.00	17.59	5.95	6.85	9.42	10.58
M12	17.57	18.00	19.85	7.05	7.95	11.30	12.70
M16	23.16	24.00	26.17	9.25	10.75	15.30	16.70
M20	29.16	30.00	32.95	11.60	13.40	19.16	20.84